

View within Community Room looking North (Toward Stage), Showing Proposed Opening

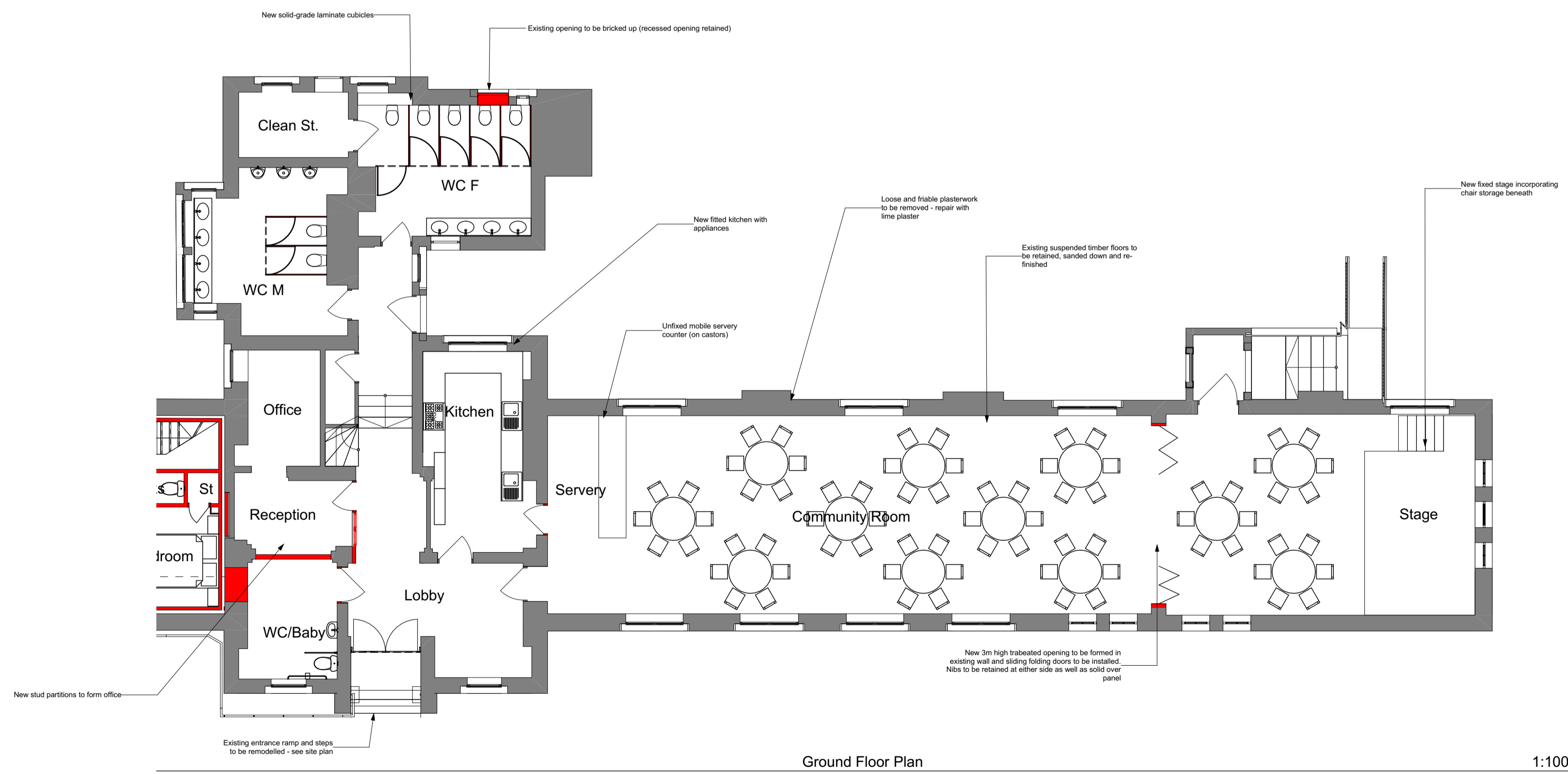

Rev	Comment	Date
A	Make WC layout amended	17/09/2021
B	Planning amendments	22/09/2021
C	Apartment Wall Detail Updated	05/10/2021
D	Existing windows added, annotations added	17/10/2021

wood | goldstraw | yorath
 ARCHITECTS QUANTITY SURVEYORS CDM CO-ORDINATORS
 Churchill House, Regent Road, Stoke on Trent, ST1 3RH.
 Tel: 01782 208000 Fax: 01782 208712 E-mail: info@woodgoldstraw.co.uk
 www.woodgoldstraw.co.uk

Client:
Novus

Project:
The Gower

Scale:
1:100 Issue Date:
17/10/2021

Sheet Size:
A1 Drawn

Title:
Community Centre Floor Plans

Drawing Number / (Revision) Revision ID
4709-02-36D **D**

CAD file path:
 X:\0 PROJECTS\4709 Novus\4709-02 The Gower, Telford\Design\Arch\CAD\HOTLINK\4709-02 H.L.
 Existing Building identified - proposed join
 Copyright: Wood Goldstraw Yorath LLP.
 Contractors are to check all dimensions on site and refer any discrepancies to the Architect immediately. This drawing has been prepared for planning purposes only and by the best of our knowledge the original digital document is accurate at the stated scale. However, we cannot accept liability for the accuracy of third party data (OS mapping, topographical survey information, etc) used in the production of this document which we have relied upon in good faith. Any dimensions are noted for reference and any further specific dimensional information can be provided upon request.